

Installation Instruction

1. Open packing box, take out motorcycle and accessories.



2. All tools you need as below; Matching pot with scale mark.



3. Remove the front brake caliper; prepare install front wheel.



4. Install the front wheel, put the spacer before fixed nut.



5. Install the front brake caliper.

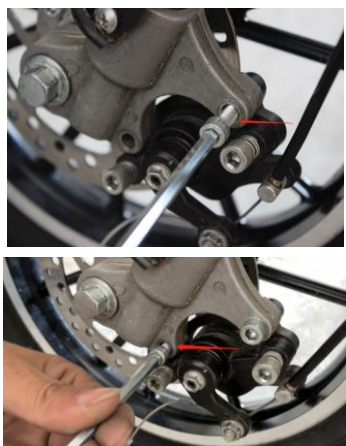

6. Install the handle-bar and rear shock.



7. Install the front fender.



8. Install the front number plate.

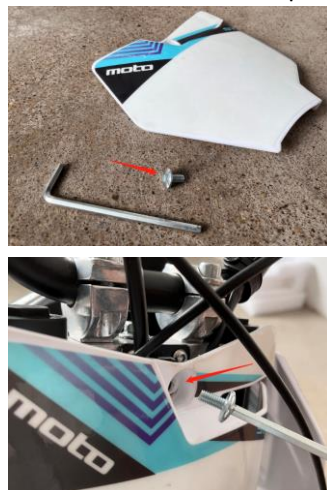

9. Install the handle-bar pad.
Start enjoy your riding!

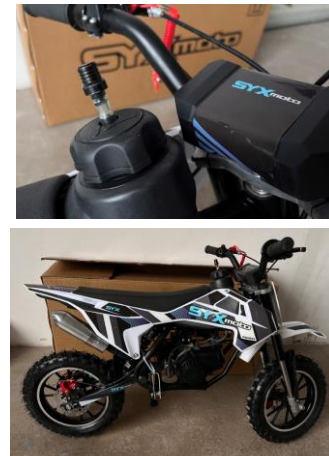

Scan to the QR code for
quick start guide

SYXmoto
service@syxmoto.com